



AC Variable Frequency Drive Arctic Land Drilling Rig

Year Built: 2011

Mast

Type: Cantilever
Height: 152 ft
Max. Allowable Static Hook load : 750,000 lbs
Racking Capacity (5 in DP): 20,000 ft

Drawworks

Drawworks Make: NOV ADS-10SD
Total Input Power: 2,300 hp
Number of Motors: 2
Drilling Line: 1-3/8 in.

Traveling Equipment

Traveling Block Make/Model: NOV
Rated Load: 375 tons

Substructure

Type: Custom
Rig Floor Height: 45 ft
Clear Working Height: 21 ft
Setback Capacity: 500,000 lbs

Rotary Equipment

Top Drive Make/Model: NOV TDS-11SAE
Hoisting Capacity: 500 tons
Maximum Continuous Torque: 58,800 ft-lb
Total Input Power: 1,200 hp
Number of Motors: 2
Rotary Table Make/Model: NOV RST
Size: 37-1/2 in.
Static Load Rating: 375 tons

BOP System

Annular Preventer Make/Model: NOV Shaffer
Size: 13-5/8 in
Pressure Rating: 5,000 psi
Annular Preventer Make/Model: Hydril MSP
Size: 21-1/4 in
Pressure Rating: 2,000 psi
Ram Preventer Make/Model: NOV Single T3 Model 6012
Size: 13-5/8 in
Pressure Rating: 5,000 psi
Ram Preventer Make/Model: NOV Double T3 Model 6012
Size: 13-5/8 in
Pressure Rating: 5,000 psi



Gensets

Engine Make/Model: CAT 3516C-HD
Generator Make/Model: Kato 2500 kVA
Number of Gensets: 3

Power Distribution

Gen. Control Make/Model: Woodward GCP-31
Power Distribution: AC 600V

Mud Pumps

Pump Make/Model: NOV 12-P-160
Total Input Power per Pump: 1600 hp
Pressure Rating: 5,000 psi
Number of Pumps: 2

Mud Handling/Solids Control

Total Mud Volume: 1,663 bbls
Shale Shaker Make/Model: Derrick Dual Pool 628
Number of Shakers: 3
Desilter Make/Model: Derrick Round 16-Cone
Number of Desilters: 1
Degasser Make/Model: Derrick Vacu-Flo 1200
Number of Degassers: 1

Moving System

Type: Self-Propelled Wheeled System
Load Capacity: Drill Module: 4,280,000 lbs
Mud Module: 3,520,000 lbs
Utility Module: 3,520,000 lbs

Other

Power Generation
Emissions: Tier 4 Compliant After Exhaust System



Note: Equipment subject to client-specific requirements. No part of this document may be reproduced or transmitted without prior consent of Parker Drilling. Rev 08/23

Energy. Well engineered.

Find out more at parkerwellbore.com

©2021 Parker Wellbore. All Rights Reserved.

2103 CityWest Blvd Suites. 300-400
Houston, TX 77042



AC Variable Frequency Drive Arctic Land Drilling Rig

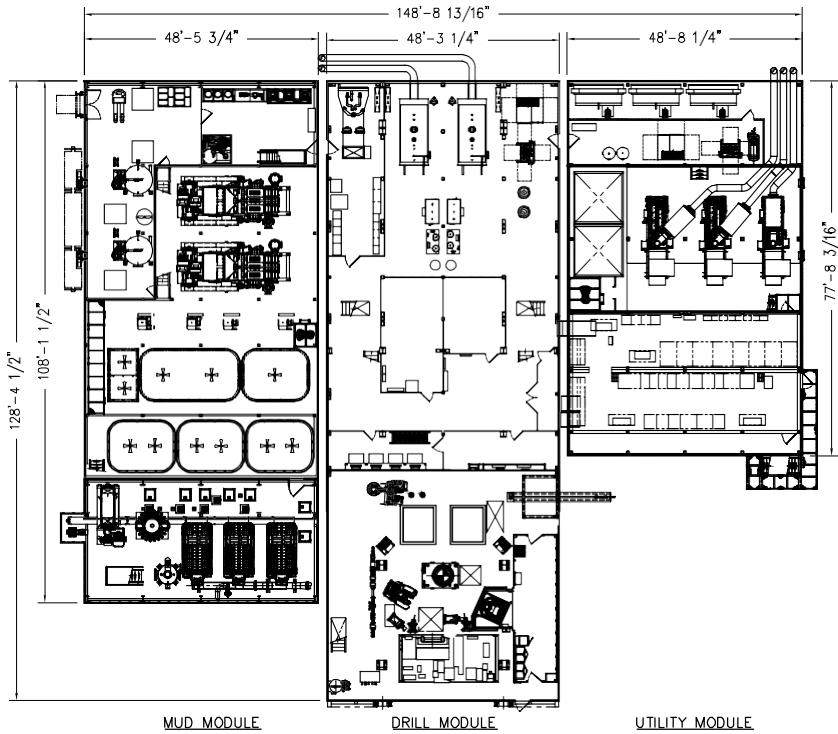

GENERAL ARRANGEMENT - PLAN VIEW

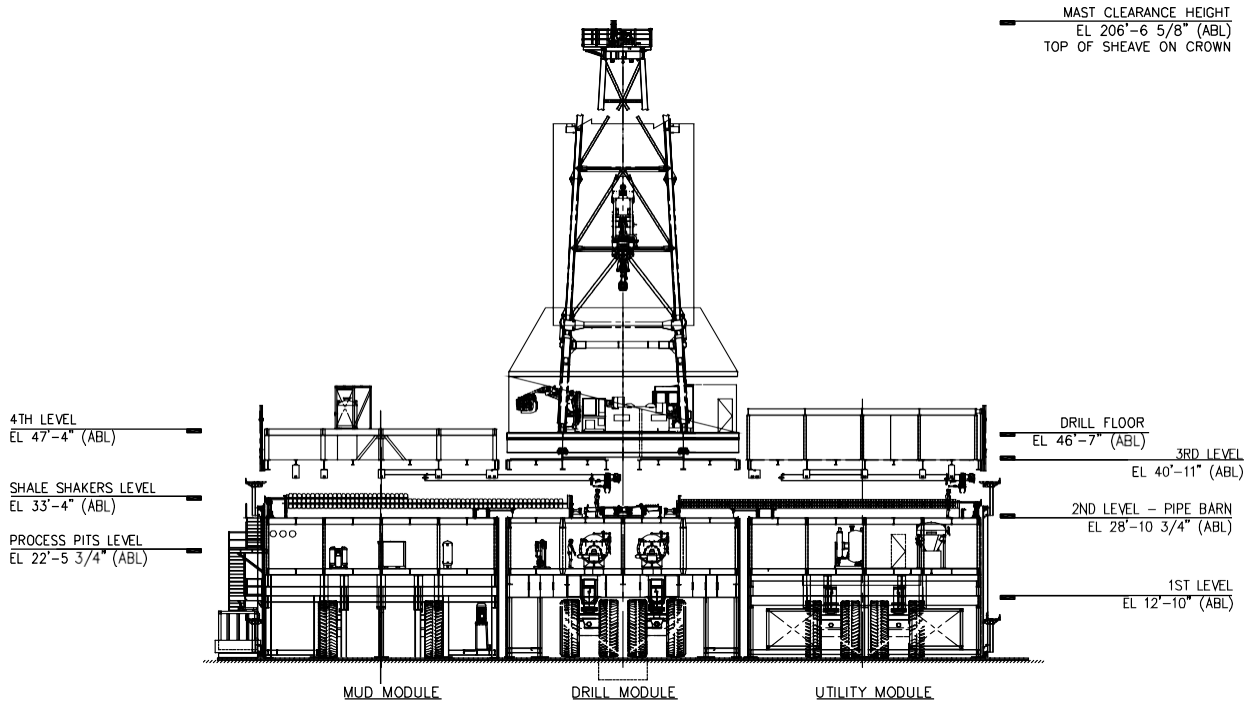

GENERAL ARRANGEMENT - AFT ELEVATION

Note: Equipment is subject to client-specific requirements. No part of this document may be reproduced or transmitted without the prior consent of Parker Wellbore. Rev 08/23

Energy. Well engineered.

Find out more at parkerwellbore.com

2103 CityWest Blvd Suites. 300-400
Houston, TX 77042